

# Eastgate Crossing

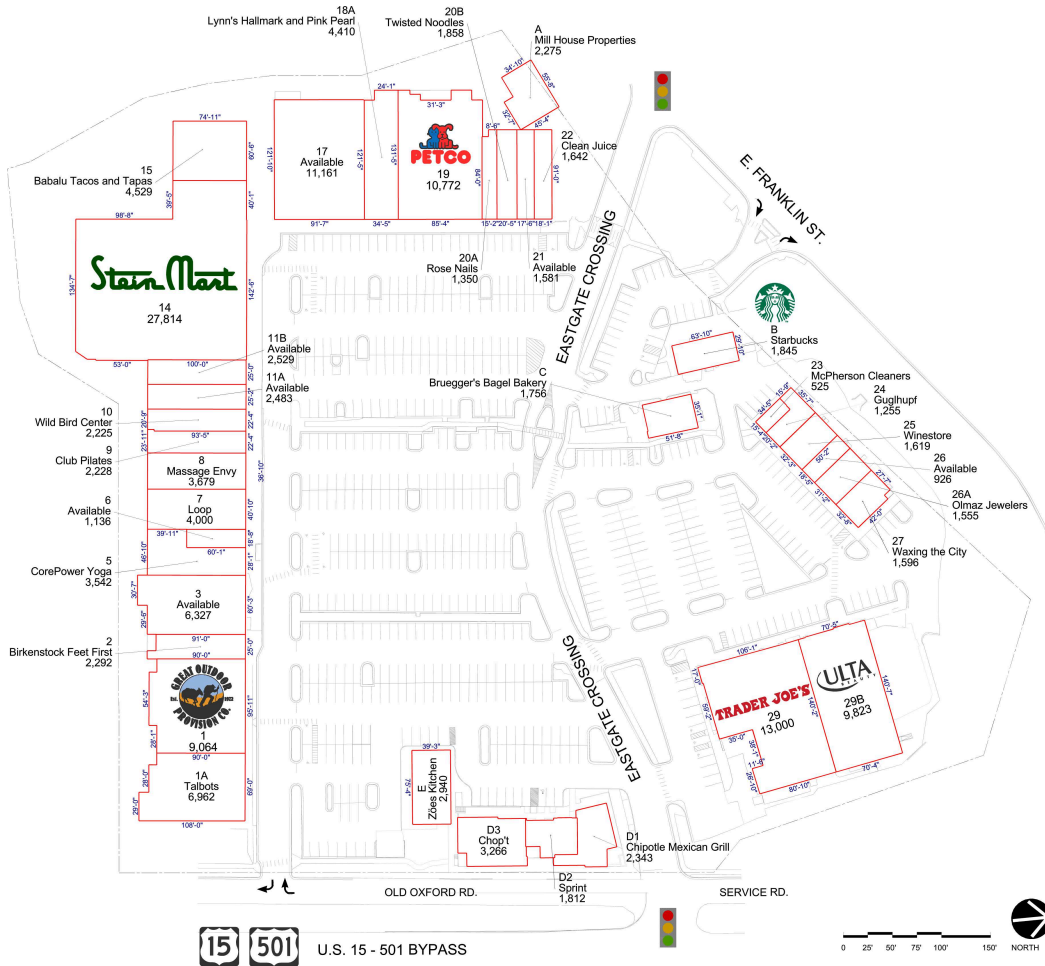

|                           |           |                                    |           |
|---------------------------|-----------|------------------------------------|-----------|
| 26 AVAILABLE              | 926 SF    | 1 Great Outdoor Provision Co.      | 9,064 SF  |
| 21 AVAILABLE              | 1,581 SF  | 1A Talbots                         | 6,962 SF  |
| 6 AVAILABLE               | 2,233 SF  | 2 Birkenstock Feet First           | 2,292 SF  |
| 11A AVAILABLE             | 2,483 SF  | 5, 5P CorePower Yoga               | 2,472 SF  |
| 11B AVAILABLE             | 2,529 SF  | 7 Loop                             | 4,000 SF  |
| 3 AVAILABLE               | 6,327 SF  | 8 Massage Envy                     | 3,679 SF  |
| 17 AVAILABLE              | 11,161 SF | 9 Club Pilates                     | 2,228 SF  |
| A Mill House Properties   | 2,275 SF  | 10 Wild Bird Center                | 2,225 SF  |
| B Starbucks               | 1,845 SF  | 14 Stein Mart                      | 27,814 SF |
| C Bruegger's Bagel Bakery | 1,756 SF  | 15 Babalu Tacos and Tapas          | 4,529 SF  |
| D1 Chipotle Mexican Grill | 2,343 SF  | 18A Lynn's Hallmark and Pink Pearl | 4,410 SF  |
| D2 Sprint                 | 1,812 SF  | 19 Petco                           | 10,772 SF |
| D3 Chopt                  | 3,266 SF  | 20A Rose Nails                     | 1,350 SF  |
| E Zoes Kitchen            | 2,940 SF  | 20B Twisted Noodles                | 1,858 SF  |

# Eastgate Crossing

---

|                       |          |                    |           |
|-----------------------|----------|--------------------|-----------|
| 22 Clean Juice        | 1,642 SF | 26A Olmaz Jewelers | 1,555 SF  |
| 23 McPherson Cleaners | 525 SF   | 27 Waxing the City | 1,596 SF  |
| 24 Guglhupf           | 1,255 SF | 29 Trader Joe's    | 13,000 SF |
| 25 Winestore          | 1,619 SF | 29B ULTA Beauty    | 9,823 SF  |