

TOWN CENTER OF NEW BRITAIN

New Britain, PA

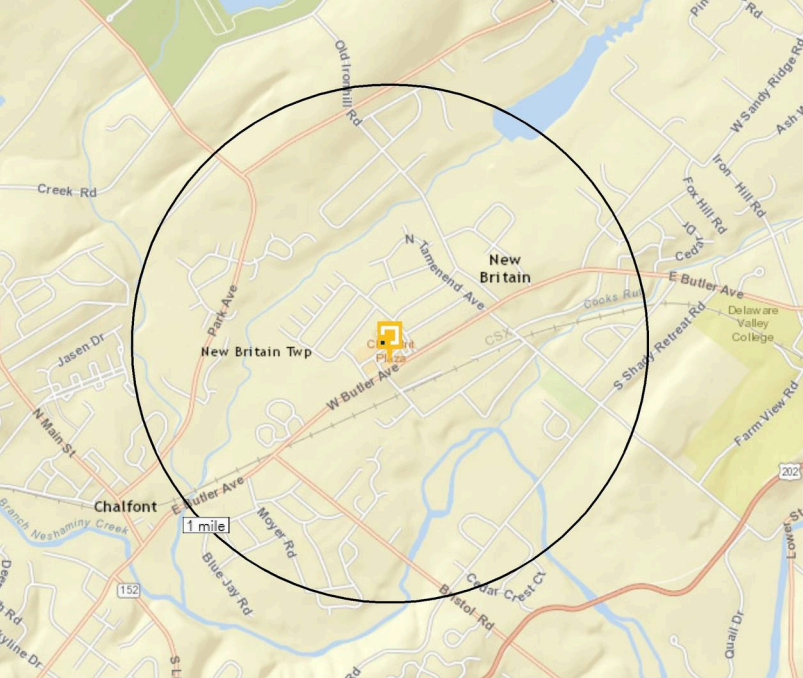

1 MILE RADIUS



5 MILE RADIUS

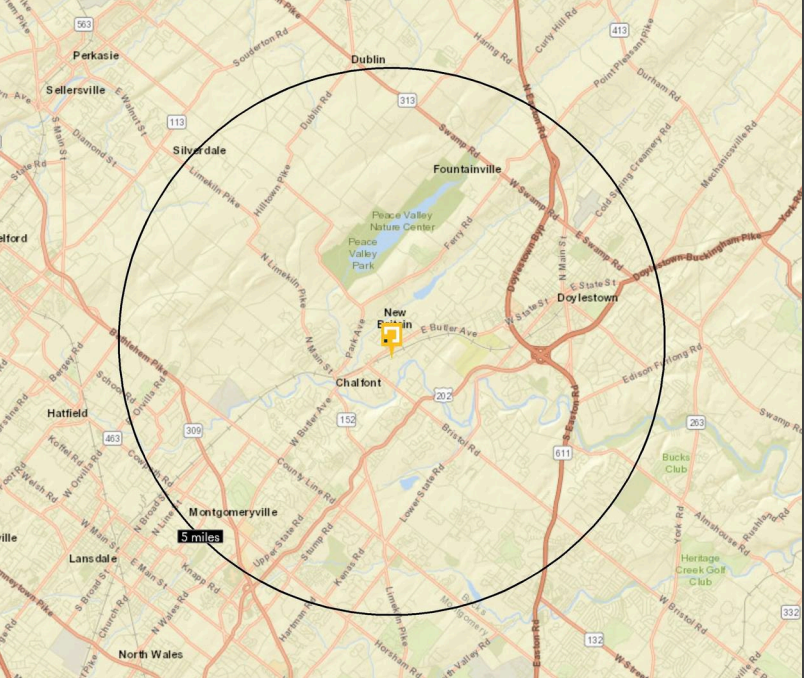

Town Center of New Britain is located in Bucks County and is situated prominently on W Butler Ave (Rt 202), a main thoroughfare from Montgomeryville to Doylestown. The property benefits from an affluent population base with average household incomes above \$120,000 within a 3 mile radius. The property includes Giant, Rite Aid, Dollar Tree, and Revolve Fitness among many others.

TOWN CENTER OF NEW BRITAIN

426 Town Center
New Britain, PA 18901



GLA
124,000 SF

ACREAGE
17

COUNTY
Bucks

TYPE
Community

PARKING SPACES
644

DEMOGRAPHICS

	POPULATION	DAYTIME POPULATION	HOUSEHOLDS	MEDIAN HHI	AVERAGE HHI	MEDIAN AGE	COLLEGE EDUCATED
1 MILE	4,317	3,745	1,541	\$101,195	\$133,596	44	50%
3 MILE	33,821	29,427	12,436	\$108,164	\$141,342	43	53%
5 MILE	97,942	101,556	36,108	\$106,270	\$138,327	44	52%

LEASING CONTACT:

James Dotson
 jdotson@federalrealty.com
 (484) 419-1218

Jeff Fischer
 jfischer@federalrealty.com
 (484) 419-1205

TOWN CENTER OF NEW BRITAIN

New Britain, PA

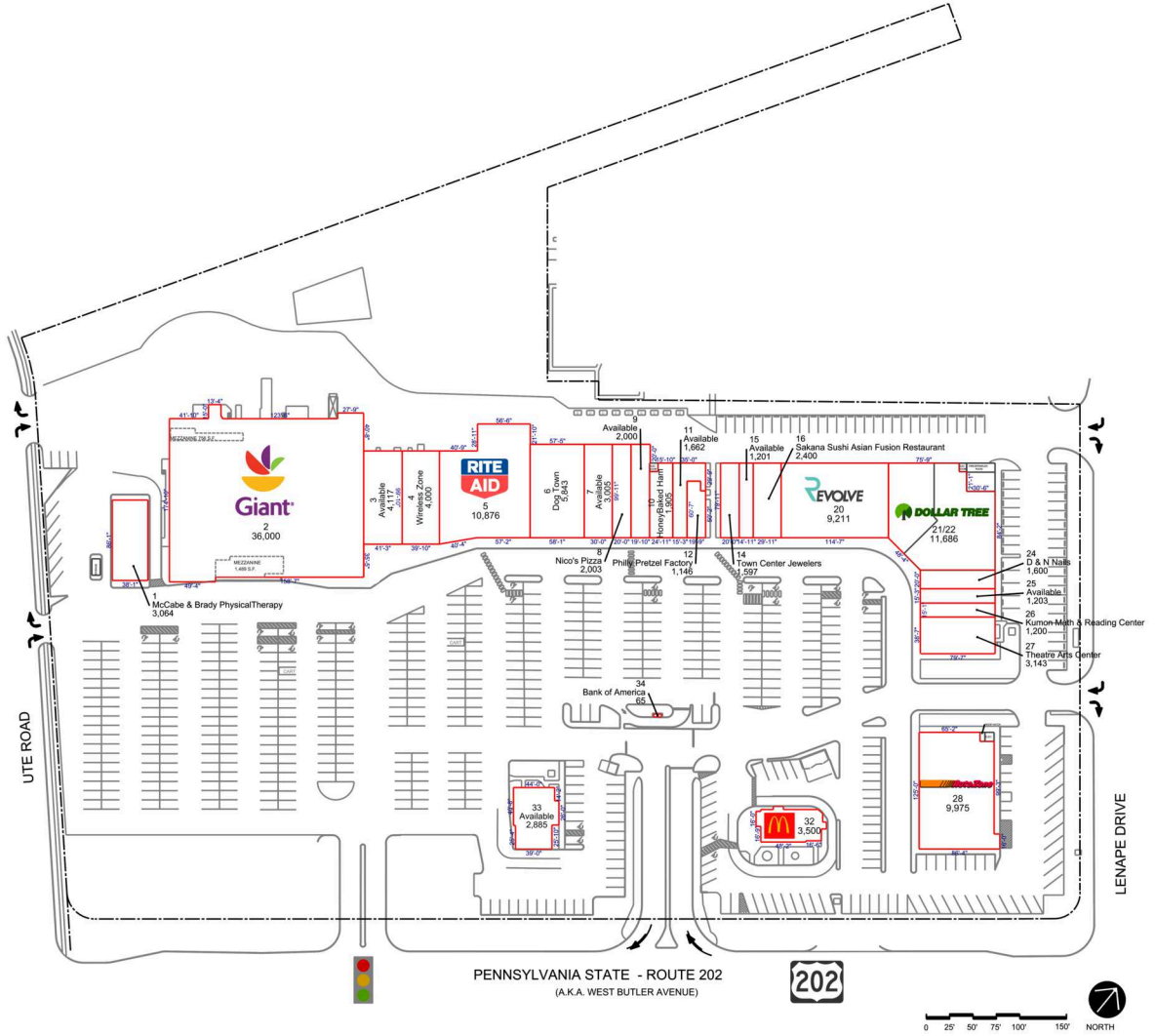

LEASING CONTACT:

James Dotson | jdotsen@federalrealty.com | (484) 419-1218
Jeff Fischer | jfischer@federalrealty.com | (484) 419-1205

www.federalrealty.com/newbritain

The parties acknowledge that this Plan is for identification purposes only and does not constitute any covenant, representations, or warranty by Landlord that any existing or future conditions shown exists, or that, if they do exist, will continue to exist through out all or any part of the lease term, except to the extent such covenant, representation or warranty is expressly set forth in the Lease.