

SYLMAR TOWNE CENTER

Sylmar, CA

1 MILE RADIUS

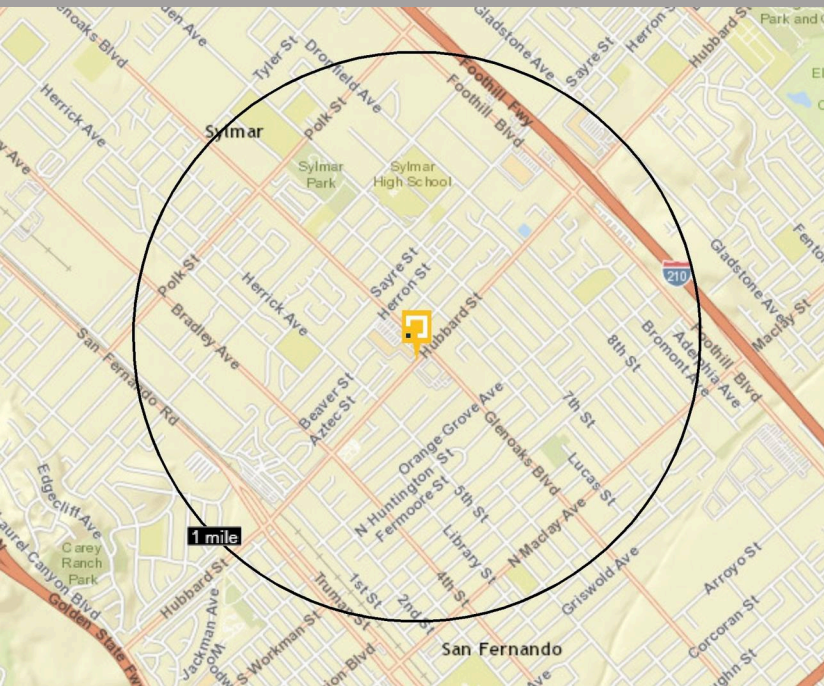

5 MILE RADIUS

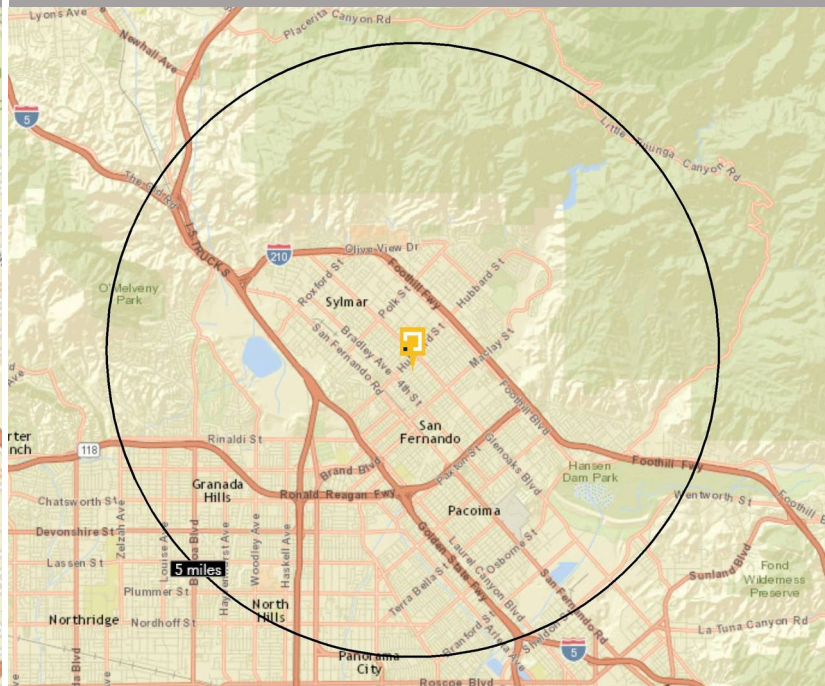

Sylmar Towne Center is located on the desirable northwest corner of Glenoaks Boulevard and Hubbard Street in the San Fernando Valley. This 148,000 square foot community retail hub features a multitude of shops and restaurants including Popeye's, CVS Pharmacy, Food 4 Less, and Big Lots.

SYLMAR TOWNE CENTER

12652 Glenoaks Blvd.
Sylmar, CA 91342



GLA
148,000 SF

ACREAGE
12

COUNTY
Los Angeles

TYPE
Neighborhood

PARKING SPACES
502

DEMOGRAPHICS

	POPULATION	DAYTIME POPULATION	HOUSEHOLDS	MEDIAN HHI	AVERAGE HHI	MEDIAN AGE	COLLEGE EDUCATED
1 MILE	42,768	30,608	10,405	\$59,640	\$75,037	31	13%
3 MILE	184,648	162,621	44,284	\$63,433	\$80,095	32	15%
5 MILE	377,393	300,619	95,173	\$65,818	\$85,255	34	20%

LEASING CONTACT:

Rosa DeLuna
 rosa@primestor.com
 (213) 223-5512

SYLMAR TOWNE CENTER

Sylmar, CA

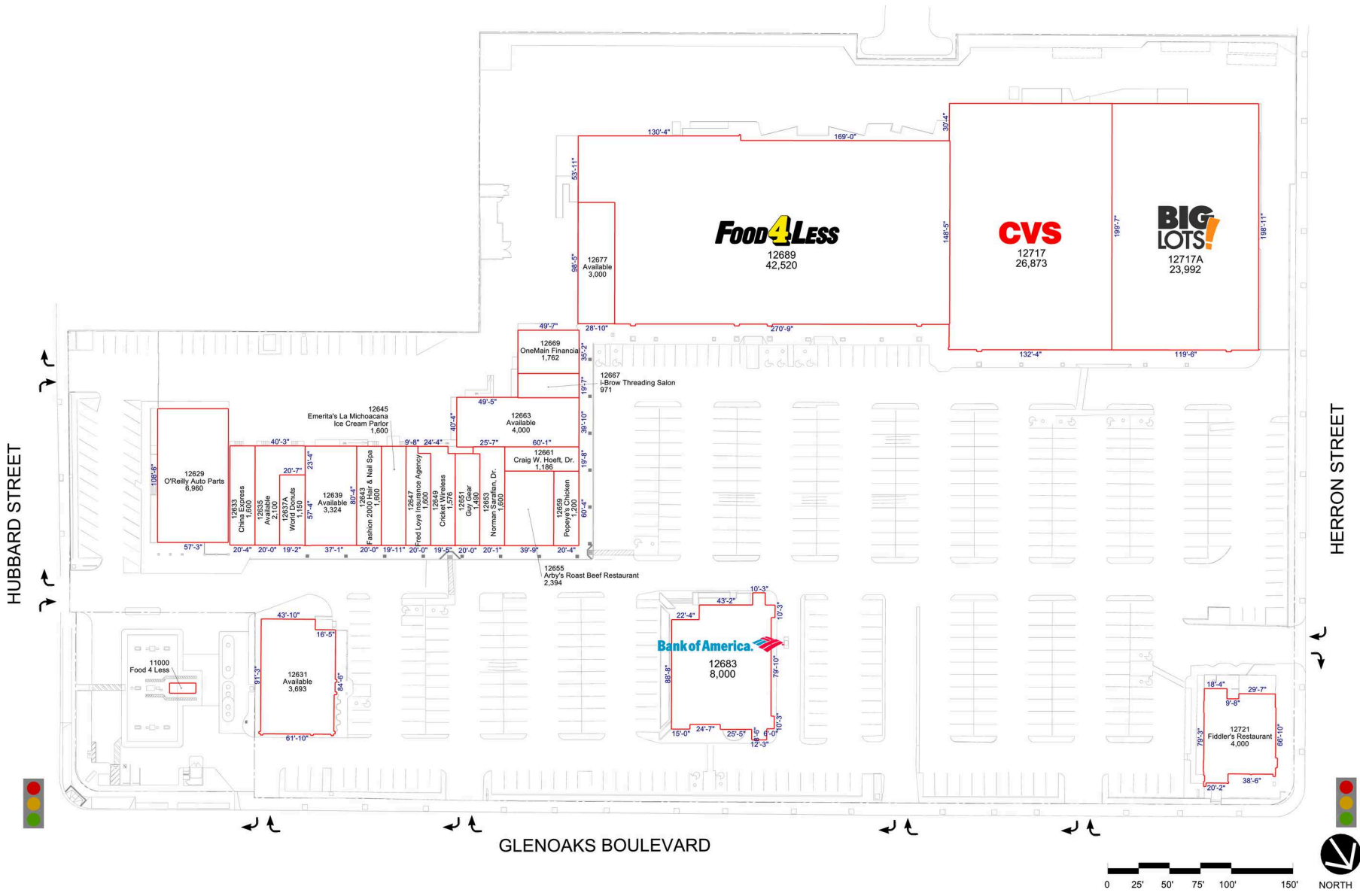

LEASING CONTACT:

Rosa DeLuna | 📧 rosa@primestor.com | 📞 (213) 223-5512

www.federalrealty.com/sylmartownecenter

The parties acknowledge that this Plan is for identification purposes only and does not constitute any covenant, representations, or warranty by Landlord that any existing or future conditions shown exists, or that, if they do exist, will continue to exist through out all or any part of the lease term, except to the extent such covenant, representation or warranty is expressly set forth in the Lease.