

SANTANA ROW

San Jose, CA

| Unit | Tenant Name | GLA (SF) |
|-------|--------------------------------|----------|
| 105 | El Jardin | 660 |
| 106 | El Jardin | 660 |
| 107 | El Jardin | 660 |
| 1010 | BoConcept San Jose | 3,820 |
| 1040 | Vintage Wine Bar | 429 |
| 2005 | Shoe | 2,840 |
| 2010 | Tacolicious | 2,191 |
| 3005 | Asap | 1,081 |
| 3007 | Tumi | 1,568 |
| 3020 | Soil Supply | 4,425 |
| 3030 | Tumi | 659 |
| 3035 | Spence Diamonds | 1,864 |
| 3040 | Everything But Water | 1,040 |
| 3045 | Cocola | 2,248 |
| 3100 | Strata | 5,978 |
| 3105 | Strata | 900 |
| 3110 | Free People | 1,804 |
| 3115 | lbtz | 2,710 |
| 3120 | Amazon Books | 5,420 |
| 4005 | Warby Parker | 1,344 |
| 4020 | Paper Source | 2,688 |
| 4025 | Bonobos | 1,839 |
| 4035 | Inullem athletica | 5,065 |
| 4040 | Available | 2,378 |
| 4050 | Songlax Hut | 475 |
| 4055 | Pizza Antica | 4,186 |
| 4070 | Kendra Scott | 1,470 |
| 4075 | Batwin | 2,000 |
| 4080 | Low & Gray | 2,514 |
| 4095 | Madewell | 3,524 |
| 5000 | Scotch & Soda | 1,840 |
| 5005 | Kali Spade | 2,391 |
| 5015 | Tommy Bahama | 3,004 |
| 5015S | Tommy Bahama | 3,376 |
| 5020 | Lavande Nail Spa | 2,378 |
| 5020 | Federal Realty | 3,096 |
| 5035 | Bathamine Salon & Barber | 556 |
| 5040 | Pressed Juicery | 3,894 |
| 5050 | Rosa McCann's Irish Pub & Res | 3,894 |
| 6007 | Native Shoes | 1,505 |
| 6010 | Fjallraven | 1,534 |
| 6020 | Frappo Uomo | 1,281 |
| 7000 | Available | 1,911 |
| 7005 | Marine Layer | 749 |
| 7010 | Sugrime | 983 |
| 7020 | Chick | 3,197 |
| 7035 | SoulCycle | 3,151 |
| 7050 | Drybar | 2,211 |
| 7060 | Boutai Spa and Wellness | 1,861 |
| 7070 | W's Salon | 1,368 |
| 7080 | Laser Away | 1,571 |
| 7105 | Available | 1,179 |
| 7110 | Loft | 5,884 |
| 7115 | Boutique Harajuku | 1,202 |
| 7135 | Vintage Wine Merchants | 1,840 |
| 7145 | LifePlus Pharmacy | 1,394 |
| 7150 | Amber India Restaurant | 5,120 |
| 7160 | Tranquility Dental | 1,416 |
| 7165 | Penelope Boutique | 1,056 |
| 7175 | Atelier Studio | 1,634 |
| 7180 | Available | 2,321 |
| 7193 | U.S. Bank National Association | 4,847 |
| 7195 | Albby | 2,897 |
| 8000 | Brandy Melville | 3,997 |
| 8005 | 100% Pure | 450 |
| 8010 | Ted Baker | 2,914 |
| 8020 | Oakley | 3,112 |
| 8025 | Optical Illusions | 1,787 |
| 8035 | Village Cafe | 3,291 |
| 8100 | EMC Seafood & Raw Bar | 3,313 |
| 8110 | Available | 670 |
| 8115 | Fantasia Coffee & Tea | 800 |
| 8120 | Available | 1,482 |
| 8125 | MaDo | 1,717 |
| 8130 | Available | 2,837 |
| 11010 | Mendocino Farms Sandwich Mkt | 2,822 |
| 11015 | Left Wing | 1,157 |
| 13007 | Available | 331 |
| 13010 | Pluz's | 3,921 |
| 13030 | Veggie Grill | 2,261 |
| 13040 | Counter | 2,406 |
| 13050 | Maggianno's | 375 |
| K001 | Poke Bar | 450 |
| K002 | Smitten Ice Cream | 556 |

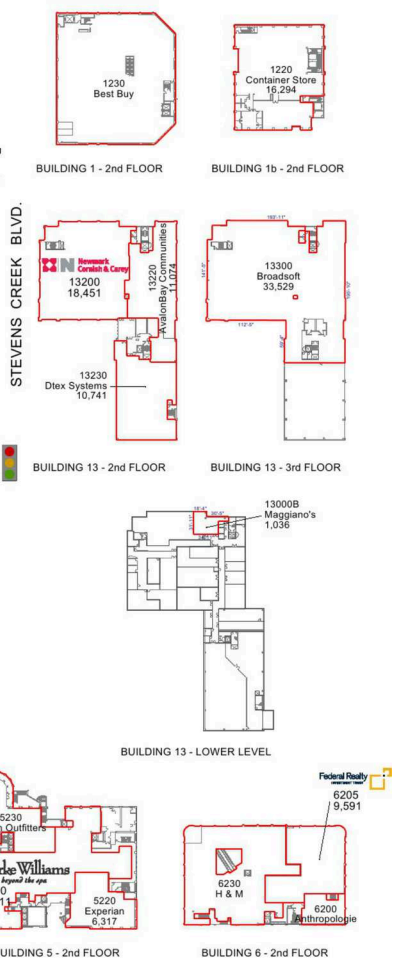
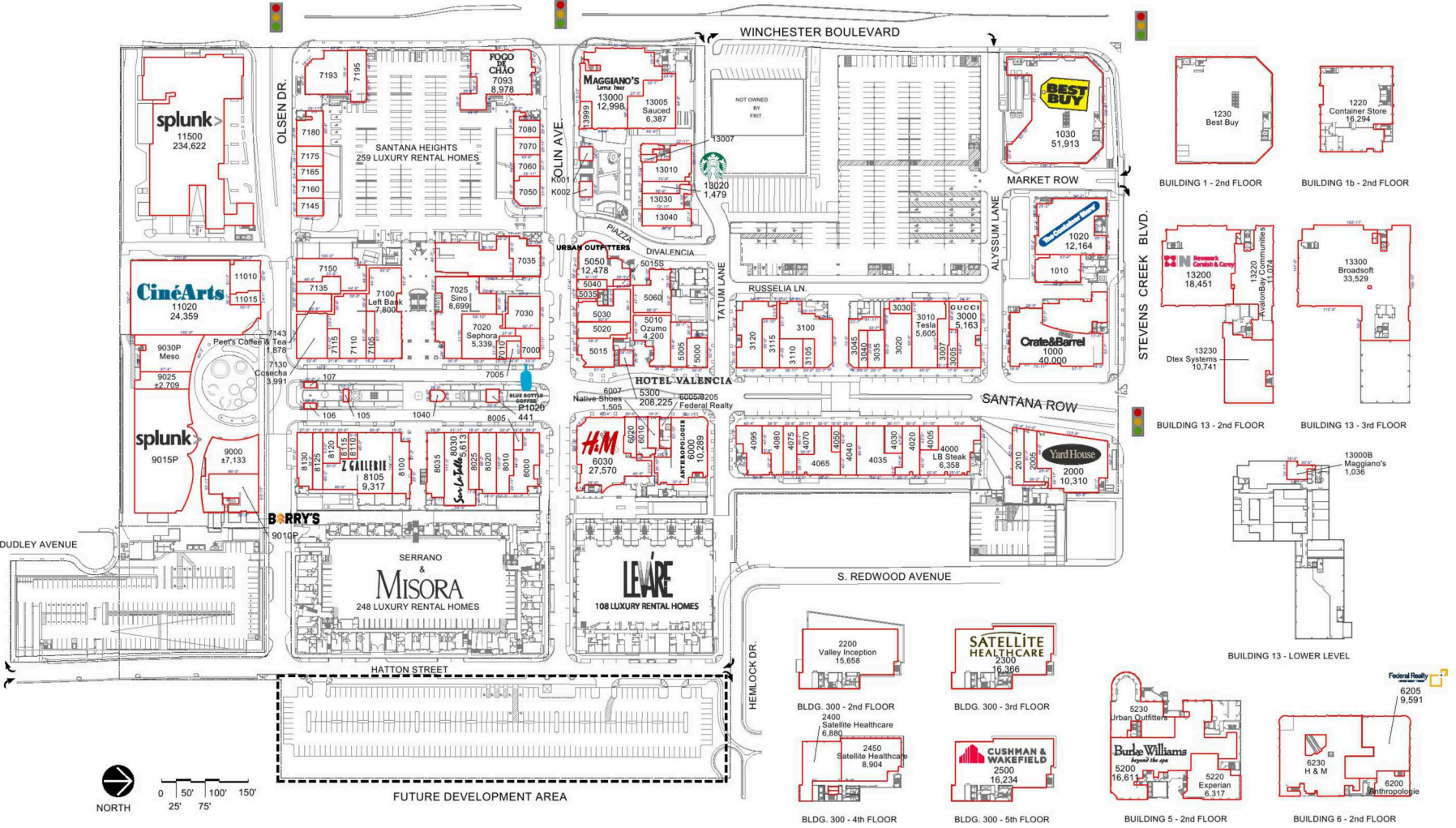

LEASING CONTACT:

Jeff Kreshek | jkreshek@federalrealty.com | (310) 414-5285
 Christian Irwin | cirwin@federalrealty.com | (310) 414-5286

www.federalrealty.com/santanarow

The parties acknowledge that this Plan is for identification purposes only and does not constitute any covenant, representations, or warranty by Landlord that any existing or future conditions shown exists, or that, if they do exist, will continue to exist through out all or any part of the lease term, except to the extent such covenant, representation or warranty is expressly set forth in the Lease.